

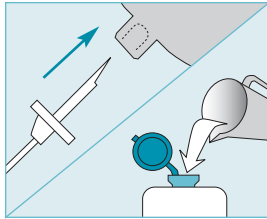

\* These instructions are not a substitute for the operator's manual.  
Be sure to read the operator's manual thoroughly prior to operating the pump.

### Priming and Loading the Disposable Set



**STEP 1**  
If you are using the spike set with a vented bottle or pre-filled bag, remove protective cover from spike, and insert spike into adapter of formula container.

If you are using the 500ml or 1200ml disposable set, hold bag upright and pour in feeding solution. Close cap securely.

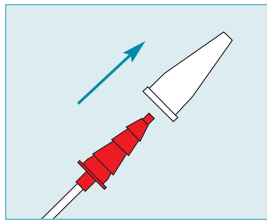

**STEP 2**  
Remove protective cover from barbed adapter.

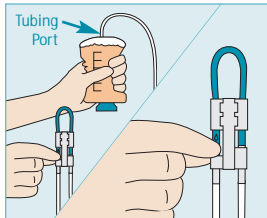

**STEP 3**  
Turn bag upside down and gently squeeze. Tilt bag as needed to keep air at tubing port. At the same time, gently pinch teal colored tubing **below** the "⚡" symbol. Hold this position until air is removed from tubing. Gently squeeze bag at same time to assist fluid flow.

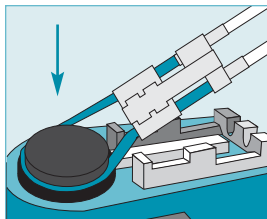

**STEP 4**  
Loop silicone tubing around pump wheel stretching lightly. Seat cassette into pump. Close pump door.

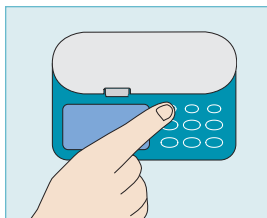

**STEP 5**  
Press and hold ON/OFF key for 1.5 seconds to turn pump on. If any air remains in tubing, press and hold the PRIME key until formula reaches the red barbed adapter.

\* See other side for pump operation instructions.



\* These instructions are not a substitute for the operator's manual.  
Be sure to read the operator's manual thoroughly prior to operating the pump.

### Programming and Running the Pump

Before attempting to program the pump, be sure to prepare the disposable set with enteral feeding solution. \* See other side for delivery set priming and loading instructions.

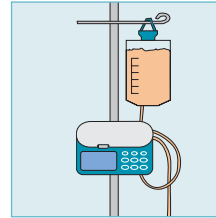

**STEP 1**  
Hang feeding container so that the bottom of the bag is at or above the level of the pump door.  
- OR -  
Fit pump and set into a ZEVEX carry pack, securing pump, bag and tubing with the pack's straps.



**STEP 2**  
Press and hold ON/OFF key for 1.5 seconds to turn pump on. After running the self test, display will show last programmed rate.



**STEP 3**  
Program the prescribed rate using the + and - keys.



**STEP 4**  
Press RATE/DOSE key to display dose. Program the prescribed dose using the + and - keys. If an interval feeding is required or convenient, continue to Step 5. If not, skip to Step 6.



**STEP 5**  
Press the FEED INT key to display feeding interval. Clear the feeding interval by pressing the CLEAR key, or program the desired number of hours and minutes using the + and - keys.



**STEP 6**  
Press the RUN/PAUSE key to start the pump.



**STEP 7**  
When feeding is complete, press the ON/OFF key for 1.5 seconds to turn the pump off.

\* Pump can be paused at any time by pressing the RUN/PAUSE key again.

Key sequence for programming pump.

